

# SWING DOORS / PIVOT DOORS

## SLIDING DEAD BOLT, 85 mm BETWEEN AXES

## 184 RANGE

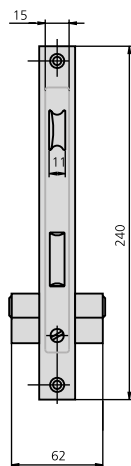

### CHARACTERISTIC

- 22 mm or 24 mm front plate
- 11mm reversible latch bolt
- 15 mm box
- 8mm square ruler
- 2 nylon escutcheons ref. ES1984
- Cylinder set screw
- Designed according to UNE-EN 12209:2004

### VERSIONS

- Spindle adapter kit

### OPTIONAL ACCESSORIES

- Complete range of **strike plates**
- Complete range of **cylinders**
- **Electric strike plate option**

DESCRIPTION	REF.	MEASUREMENTS			FINISH		UNITS	
		B	A	CAM	FRONT PLATE	CYLINDER		

- Latch bolt and dead bolt
- Cylinders:
  - Short cam 101C3030/4
  - Long cam 101L3030/4

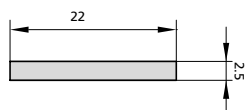
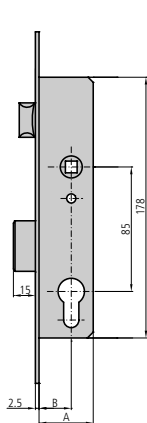

184/21/0	18	31	13,25	HN	CN	1	20
184/21/6D	18	31	15	AI	CN	1	20
184/23/0	20	33	13,25	HN	CN	1	20
184/23/6	20	33	13,25	AI	CN	1	20
184/25/0	22	37	15	HN	CN	1	20
184/25/6	22	37	15	AI	CN	1	20
184/28/0	25	38	13,25	HN	CN	1	20
184/28/6	25	38	13,25	AI	CN	1	20
184/30/0	27	42	15	HN	CN	1	20
184/30/6	27	42	15	AI	CN	1	20
184/33/0	30	43	13,25	HN	CN	1	20
184/33/6	30	43	13,25	AI	CN	1	20
184/35/0	32	47	15	HN	CN	1	20
184/35/6	32	47	15	AI	CN	1	20

- Dead bolt only
- Cylinders:
  - Short cam 101C3030/4
  - Long cam 101L3030/4

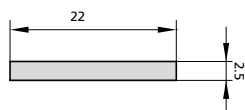
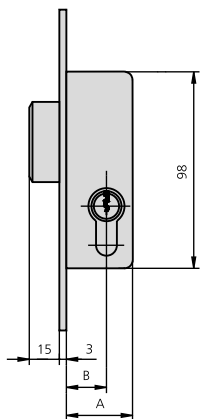

184A21/6	18	31	13,25	AI	CN	1	20
184A21/6D	18	31	15	AI	CN	1	20
184A23/6	20	33	13,25	AI	CN	1	30
184A25/6	22	37	15	AI	CN	1	30
184A28/6	25	38	13,25	AI	CN	1	30
184A30/6	27	42	15	AI	CN	1	30
184A33/6	30	43	13,25	AI	CN	1	30
184A35/6	32	47	15	AI	CN	1	30

DESCRIPTION	REF.	MEASUREMENTS		CAM	FINISH		UNITS	
		B	A		FRONT PLATE	CYLINDER		

- Adjustable roller and dead bolt
- Cylinders:
  - Short cam 101C3030/4
  - Long cam 101L3030/4

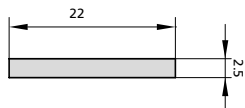
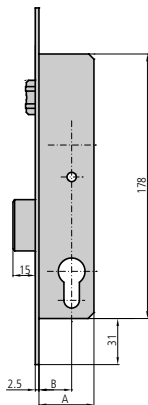

184V23/6	20	33	13,25	Al	CN	1	20
184V25/6	22	37	15	Al	CN	1	20
184V28/6	25	38	13,25	Al	CN	1	20
184V30/6	27	42	15	Al	CN	1	20
184V33/6	30	43	13,25	Al	CN	1	20
184V35/6	32	47	15	Al	CN	1	20