

PUERTAS BATIENTES / PIVOTANTES

PALANCA DESLIZANTE ENTRE EJES 85 mm.

SERIE 184

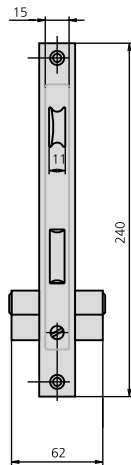

CARACTERÍSTICAS

- Frente de 22 mm ó 24 mm
- Picaporte reversible de 11 mm
- Caja de 15 mm
- Cuadrado de 8 mm
- 2 escudos de nylon ref. ES1984
- 2 terminales de frente de nylon ref. EMB196 (para frente de 22 mm)
- Tornillo de fijación de cilindro
- Según norma UNE-EN 12209:2004

VERSIONES

- Kit para adaptación a condensa

ACCESORIOS OPCIONALES

- Gama completa de **cerraderos**
- Gama completa de **cilindros**
- Opción de **cerradero eléctrico**

DESCRIPCIÓN	REF.	MEDIDAS		LEVA	ACABADOS		UDS	
		B	A		FRENTE	CILINDRO		

- Picaporte y palanca
- Cilindros:
 - Leva corta 101C3030/4
 - Leva larga 101L3030/4

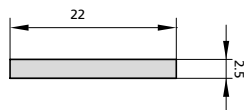
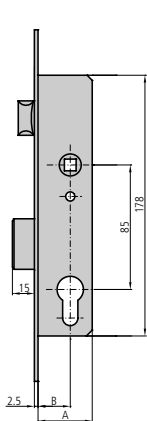

184/21/0	18	31	13,25	HN	CN	1	20
184/21/6D	18	31	15	AI	CN	1	20
184/23/0	20	33	13,25	HN	CN	1	20
184/23/6	20	33	13,25	AI	CN	1	20
184/25/0	22	37	15	HN	CN	1	20
184/25/6	22	37	15	AI	CN	1	20
184/28/0	25	38	13,25	HN	CN	1	20
184/28/6	25	38	13,25	AI	CN	1	20
184/30/0	27	42	15	HN	CN	1	20
184/30/6	27	42	15	AI	CN	1	20
184/33/0	30	43	13,25	HN	CN	1	20
184/33/6	30	43	13,25	AI	CN	1	20
184/35/0	32	47	15	HN	CN	1	20
184/35/6	32	47	15	AI	CN	1	20

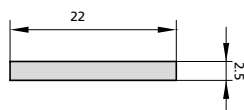
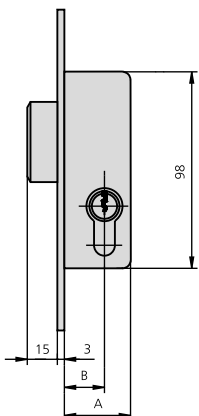

- Sólo palanca
- Cilindros:
 - Leva corta 101C3030/4
 - Leva larga 101L3030/4



184A21/6	18	31	13,25	AI	CN	1	20
184A21/6D	18	31	15	AI	CN	1	20
184A23/6	20	33	13,25	AI	CN	1	30
184A25/6	22	37	15	AI	CN	1	30
184A28/6	25	38	13,25	AI	CN	1	30
184A30/6	27	42	15	AI	CN	1	30
184A33/6	30	43	13,25	AI	CN	1	30
184A35/6	32	47	15	AI	CN	1	30

PALANCA DESLIZANTE ENTRE EJES 85 mm.

SERIE 184

DESCRIPCIÓN	REF.	MEDIDAS		LEVA	ACABADOS		UDS	
		B	A		FRENTE	CILINDRO		

- Rodillo vaivén regulable y palanca
- Cilindros:
 - Leva corta 101C3030/4
 - Leva larga 101L3030/4

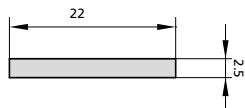
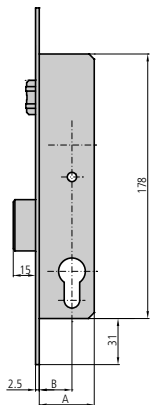

184V23/6	20	33	13,25	Al	CN	1	20
184V25/6	22	37	15	Al	CN	1	20
184V28/6	25	38	13,25	Al	CN	1	20
184V30/6	27	42	15	Al	CN	1	20
184V33/6	30	43	13,25	Al	CN	1	20
184V35/6	32	47	15	Al	CN	1	20