

PORTES BATTANTES / PIVOTANTES

PÊNE DORMANT BASCULANT ENTRE-AXES 85 mm.

SÉRIE 196

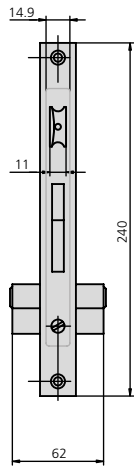

CARACTÉRISTIQUES

- Têtière inox de 22mm ou 24mm ou têtière U 24,5x6mm
- Pêne 1/2 tour réversible de 11 mm
- Pêne 1/2 tour réglable, sauf sur axe de 25 mm et 28 mm
- Boîtier de 15 mm
- Carré de 8 mm.
- 2 cache-cylindre réf. ES1984
- Vis de fixation de cylindre.

ACCESSOIRES EN OPTION

- Gamme complète de **gâches**
- Gamme complète de **cylindres**
- Option **gâches électriques**
- Cache cylindre de sécurité à vis transversantes BTI296/1N

DESCRIPTION	RÉF.	DIMENSIONS		PANNETON	FINITIONS		PIÈCES	
		B	A		TÊTIÈRE	CYLINDRE		

- Pêne demi-tour et pêne dormant
- Cylindre:
 - Panneton court 101C3030/4
 - Leva larga 101L3030/4

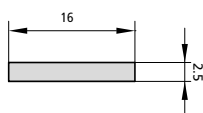

P196/25/6	22	37	15	Al	CN	1	20
P196/28/6	25	38	13,25	Al	CN	1	20
P196/30/6	27	42	15	Al	CN	1	20
P196/33/6	30	43	13,25	Al	CN	1	20
P196/35/6	32	47	15	Al	CN	1	20
P196/38/6	35	48	13,25	Al	CN	1	20

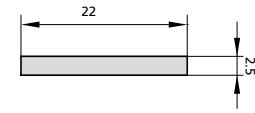
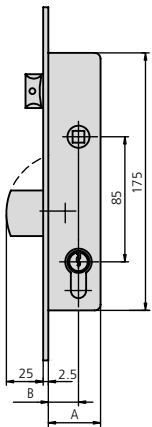

196/25/6	22	37	15	Al	CN	1	20
196/28/6	25	38	13,25	Al	CN	1	20
196/30/6	27	42	15	Al	CN	1	20
196/33/6	30	43	13,25	Al	CN	1	20
196/35/6	32	47	15	Al	CN	1	20
196/38/6	35	48	13,25	Al	CN	1	20

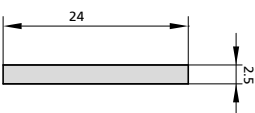

196/25/6AN	22	37	15	Al	CN	1	20
196/28/6AN	25	38	13,25	Al	CN	1	20
196/30/6AN	27	42	15	Al	CN	1	20
196/33/6AN	30	43	13,25	Al	CN	1	20
196/35/6AN	32	47	15	Al	CN	1	20
196/38/6AN	35	48	13,25	Al	CN	1	20

- Pêne uniquement
- Cylindre:
 - Panneton court 101C3030/4
 - Panneton long 101L3030/4

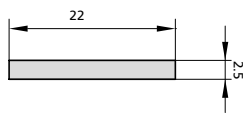
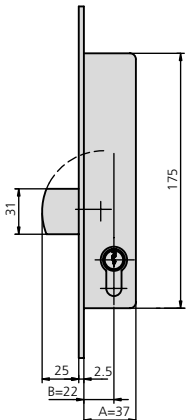

196A/25/6	22	37	15	Al	CN	1	20
196A/28/6	25	38	13,25	Al	CN	1	20
196A/30/6	27	42	15	Al	CN	1	20
196A/33/6	30	43	13,25	Al	CN	1	20
196A/35/6	32	47	15	Al	CN	1	20
196A/38/6	35	48	13,25	Al	CN	1	20

PORTES BATTANTES / PIVOTANTES
PÊNE DORMANT BASCULANT ENTRE-AXES 85 mm.
SÉRIE 196
DESCRIPTION
RÉF.
DIMENSIONS
B A
PANNETON
FINITIONS
TÊTIÈRE CYLINDRE
PIÈCES

- Demi-tour uniquement et demi cylindre
- Cylindre:
 - Panneton court 101C3010/4
 - Panneton long 101L3010/4

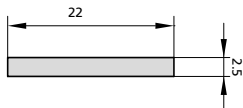
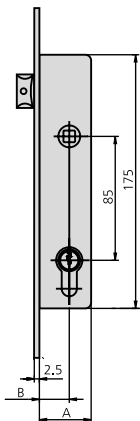

196T/25/6	22	37	15	Al	CN	1	20
196T/28/6	25	38	13,25	Al	CN	1	20
196T/30/6	27	42	15	Al	CN	1	20
196T/33/6	30	43	13,25	Al	CN	1	20
196T/35/6	32	47	15	Al	CN	1	20
196T/38/6	35	48	13,25	Al	CN	1	20

- Demi-tour uniquement sans cylindre

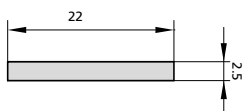
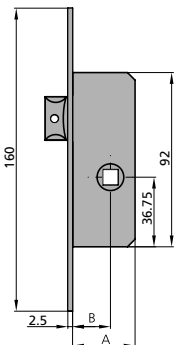

196R/25/6	22	37		Al	CN	2	20
196R/28/6	25	38		Al	CN	2	20
196R/30/6	27	42		Al	CN	2	20
196R/33/6	30	43		Al	CN	2	20
196R/35/6	32	47		Al	CN	2	20
196R/38/6	35	48		Al	CN	2	20

- Rouleau uniquement

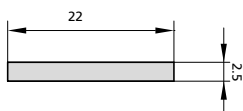
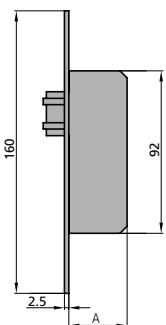

196RV/6	22	37		Al	CN	2	20
---------	----	----	--	----	----	---	----

- Rouleau réglable et pêne dormant

- Cylindre:
 - Panneton court 101C3030/4
 - Panneton long 101L3030/4

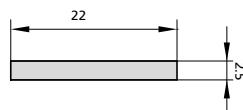
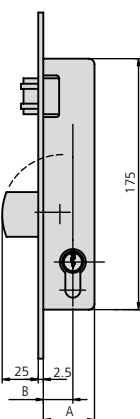

196V25/6	22	37	15	Al	CN	1	20
196V28/6	25	38	13,25	Al	CN	1	20
196V30/6	27	42	15	Al	CN	1	20
196V33/6	30	43	13,25	Al	CN	1	20
196V35/6	32	47	15	Al	CN	1	20
196V38/6	35	48	13,25	Al	CN	1	20