

SWING DOORS / PIVOT DOORS

MULTIPOINT WITH TILTING DEAD BOLT, 85 mm BETWEEN AXES

296 RANGE

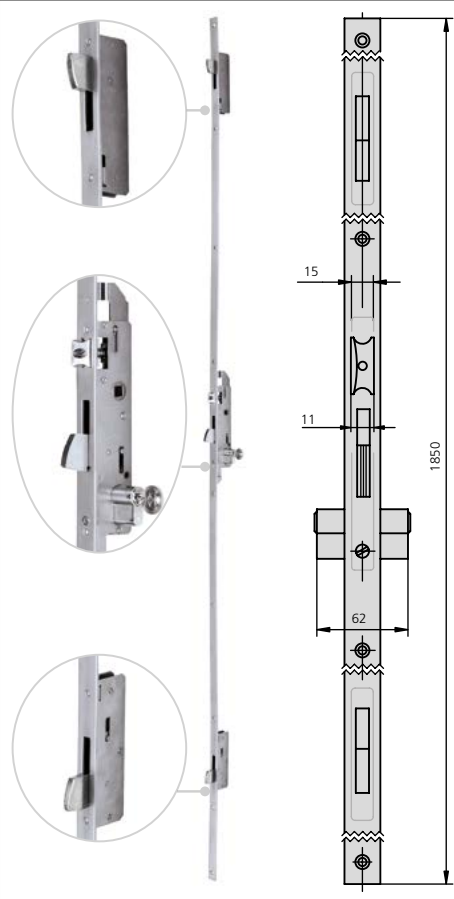

CHARACTERISTIC

- 1850x22 mm or 1850x24 mm SS flat front plate or 1850x24,5x6 mm U profile SS front plate
- 11mm reversible latch bolt
- Adjustable latch bolt, except in 25 mm and 28 mm entrance
- 15 mm box
- 8mm square ruler
- Cylinder set screw

VERSIONS

- In option 2300 mm long front plate (496 range)
- In option 1500 mm long front plate (596 range)

OPTIONAL ACCESSORIES

- Complete range of **strike plates**
- Complete range of **cylinders**
- **Electric strike plate** option

DESCRIPTION	REF.	MEASUREMENTS		CAM	FINISH		UNITS
		B	A		FRONT PLATE	CYLINDER	

- Latch bolt and dead bolt
- Cylinder not included

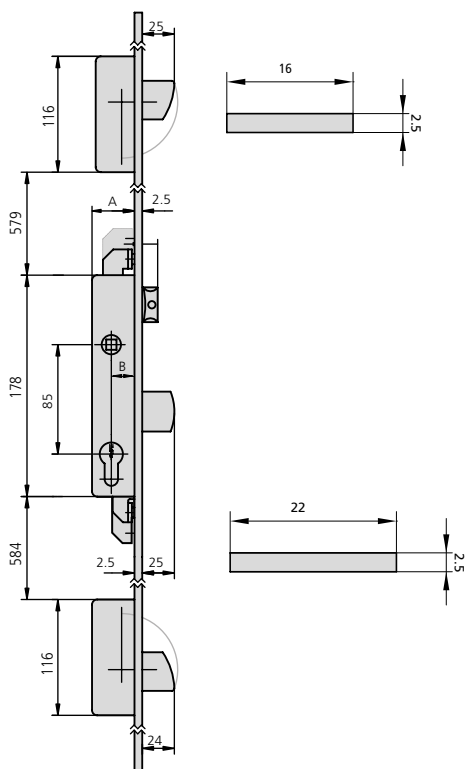

P296/25/6	22	37	15	Al	1
P296/28/6	25	38	13,25	Al	1
P296/30/6	27	42	15	Al	1
P296/33/6	30	43	13,25	Al	1
P296/35/6	32	47	15	Al	1
P296/38/6	35	48	13,25	Al	1
P296/40/6	37	52	15	Al	1
P296/45/6	42	57	15	Al	1
P296/55/6	52	67	15	Al	1

296/25/6L	22	37	15	Al	1
296/28/6L	25	38	13,25	Al	1
296/30/6L	27	42	15	Al	1
296/33/6L	30	43	13,25	Al	1
296/35/6L	32	47	15	Al	1
296/38/6L	35	48	13,25	Al	1
296/40/6L	37	52	15	Al	1
296/45/6L	42	57	15	Al	1
296/55/6L	52	67	15	Al	1

DESCRIPTION	REF.	MEASUREMENTS		CAM	FINISH		UNITS
		B	A		FRONT PLATE	CYLINDER	
	296/25/6LAN	22	37	15	Al	1	
	296/28/6LAN	25	38	13,25	Al	1	
	296/30/6LAN	27	42	15	Al	1	
	296/33/6LAN	30	43	13,25	Al	1	
	296/35/6LAN	32	47	15	Al	1	
	296/38/6LAN	35	48	13,25	Al	1	
	296/40/6LAN	37	52	15	Al	1	
	296/45/6LAN	42	57	15	Al	1	
	296/55/6LAN	52	67	15	Al	1	
		296/25/6U	18	33	15	Al	
296/28/6U		21	34	13,25	Al	1	
296/30/6U		23	38	15	Al	1	
296/33/6U		26	39	13,25	Al	1	
296/35/6U		28	43	15	Al	1	
296/40/6U		33	48	15	Al	1	
296/45/6U		38	53	15	Al	1	
296/55/6U		48	63	15	Al	1	

- Dead bolt only
- Cylinder not included

	P296A25/6	22	37	15	Al	1
	P296A28/6	25	38	13,25	Al	1
	P296A30/6	27	42	15	Al	1
	P296A33/6	30	43	13,25	Al	1
	P296A35/6	32	47	15	Al	1
	P296A38/6	35	48	13,25	Al	1
	P296A40/6	37	52	15	Al	1
	P296A45/6	42	57	15	Al	1
	P296A55/6	52	67	15	Al	1
		296A25/6L	22	37	15	Al
296A28/6L		25	38	13,25	Al	1
296A30/6L		27	42	15	Al	1
296A33/6L		30	43	13,25	Al	1
296A35/6L		32	47	15	Al	1
296A38/6L		35	48	13,25	Al	1
296A40/6L		37	52	15	Al	1
296A45/6L		42	57	15	Al	1
296A55/6L	52	67	15	Al	1	

SWING DOORS / PIVOT DOORS

MULTIPOINT WITH TILTING DEAD BOLT, 85 mm BETWEEN AXES

296 RANGE

DESCRIPTION	REF.	MEASUREMENTS		CAM	FINISH		UNITS
		B	A		FRONT PLATE	CYLINDER	
	296A25/6LAN	22	37	15	Al		1
	296A28/6LAN	25	38	13,25	Al		1
	296A30/6LAN	27	42	15	Al		1
	296A33/6LAN	30	43	13,25	Al		1
	296A35/6LAN	32	47	15	Al		1
	296A38/6LAN	35	48	13,25	Al		1
	296A40/6LAN	37	52	15	Al		1
	296A45/6LAN	42	57	15	Al		1
	296A55/6LAN	52	67	15	Al		1
		296A25/6U	18	33	15	Al	
296A30/6U		23	38	15	Al		1
296A35/6U		28	43	15	Al		1
296A40/6U		33	48	15	Al		1
296A45/6U		38	53	15	Al		1
296A55/6U		48	63	15	Al		1

- Adjustable roller and dead bolt
- Cylinder not included

	P296V25/6	22	37	15	Al		1
	P296V28/6	25	38	13,25	Al		1
	P296V30/6	27	42	15	Al		1
	P296V33/6	30	43	13,25	Al		1
	P296V35/6	32	47	15	Al		1
	P296V38/6	35	48	13,25	Al		1
	P296V40/6	37	52	15	Al		1
	P296V45/6	42	57	15	Al		1
	P296V55/6	52	67	15	Al		1
		296V25/6L	22	37	15	Al	
296V28/6L		25	38	13,25	Al		1
296V30/6L		27	42	15	Al		1
296V33/6L		30	43	13,25	Al		1
296V35/6L		32	47	15	Al		1
296V38/6L		35	48	13,25	Al		1
296V40/6L		37	52	15	Al		1
296V45/6L		42	57	15	Al		1
296V55/6L	52	67	15	Al		1	

DESCRIPTION	REF.	MEASUREMENTS		CAM	FINISH		UNITS
		B	A		FRONT PLATE	CYLINDER	
	296V25/6LAN	22	37	15	Al	1	
	296V28/6LAN	25	38	13,25	Al	1	
	296V30/6LAN	27	42	15	Al	1	
	296V33/6LAN	30	43	13,25	Al	1	
	296V35/6LAN	32	47	15	Al	1	
	296V38/6LAN	35	48	13,25	Al	1	
	296V40/6LAN	37	52	15	Al	1	
	296V45/6LAN	42	57	15	Al	1	
	296V55/6LAN	52	67	15	Al	1	
		296V25/6U	18	33	15	Al	1
296V30/6U		23	38	15	Al	1	
296V35/6U		28	43	15	Al	1	
296V40/6U		33	48	15	Al	1	
296V45/6U		38	53	15	Al	1	
296V55/6U		48	63	15	Al	1	